

**DESIGN REPORT**

- Legend:**
- City Boundary
  - Proposed Development Boundary
  - Proposed Road Development
  - Protect and maintain existing Gas Networks service
  - Proposed Diversion to service
  - Proposed Temporary Diversion to service
  - Decommissioned service
  - Proposed Sluice Valve
  - Existing Gas Networks service
  - Structure
  - Proposed Attenuation Pond / Infiltration Basin / Wetlands
  - Proposed Stream Diversion



San áireamh tá sonraíocht Shuirbhíreachtí Orlánáis Éireann arna atáirgeadh fúis Cheadúnas OSI Uimh. 2010/18CCMA/Comhairle Contae na Gaillimhe. Sírtaíonn atáirgeadh neamhdídartha cóipeacht Shuirbhíreachtí Orlánáis Éireann agus Rialtas na hÉireann. © Suirbhíreacht Orlánáis Éireann, 2010.

© Suirbhíreacht Orlánáis Éireann. Gach ceart ar chosaint. Uimhir cheadúnais 2010/18CCMA/Comhairle Contae na Gaillimhe.

Includes Ordnance Survey Ireland data reproduced under OSI Licence number 2010/18CCMA/Galway County Council. Unauthorised reproduction infringes Ordnance Survey Ireland and Government of Ireland copyright. © Ordnance Survey Ireland, 2010.

© Ordnance Survey Ireland. All rights reserved. Licence number 2010/18CCMA/Galway County Council.

**Clients**

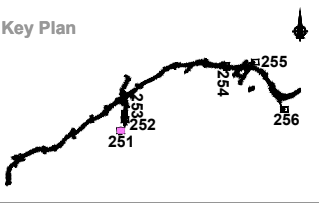

**Consultant**

Corporate House  
City East Business Park  
Ballybrit, Galway, Ireland.

Tel +353 (0)91 460675  
www.N6GalwayCity.ie  
www.arup.ie

**Job Title**  
N6 Galway City Ring Road

**Scale**  
1:1000 @ A3

**Date:**  
February 2018

Issue	Date	By	Chkd	Appd
I1	22/02/2018	AG	HK	EMC

**Drawing Title**  
Utility / Service Drawings  
Gas Diversion Requirements  
Sheet 1 of 6

**Drawing Status**

**For Information**

Job No	Drawing No	Issue
233985-00	GCOB-2700-D-251	11

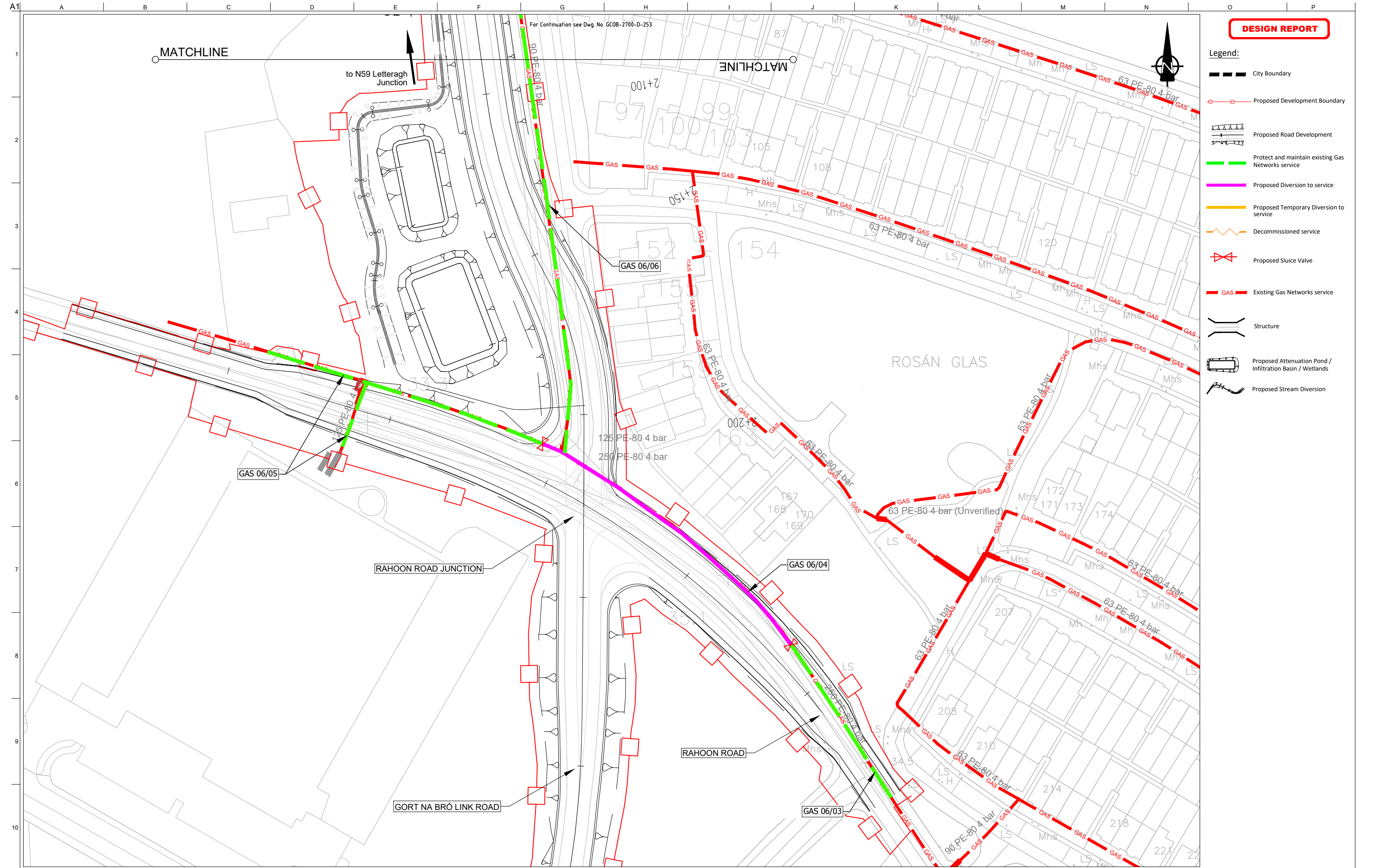

**DESIGN REPORT**

- Legend:**
- City Boundary
  - Proposed Development Boundary
  - Proposed Road Development
  - Protect and maintain existing Gas Networks service
  - Proposed Diversion to service
  - Proposed Temporary Diversion to service
  - Decommissioned service
  - Proposed Sluice Valve
  - Existing Gas Networks service
  - Structure
  - Proposed Attenuation Pond / Infiltration Basin / Wetlands
  - Proposed Stream Diversion

San áireamh tá sonraíocht Shuirbhíreacht Orlánáis Éireann arna áitirgeadh fúis Cheadúnas OSI Uimh. 2010/18CCMA/Comhairle Contae na Gaillimhe. Sírálainn áitirgeadh neamhdaraithe cóipeacht Shuirbhíreacht Orlánáis Éireann agus Rialtas na hÉireann. © Suirbhíreacht Orlánáis Éireann, 2010.

© Suirbhíreacht Orlánáis Éireann. Gach ceart ar chosaint.  
Uimhir cheadúnais 2010/18CCMA/Comhairle Contae na Gaillimhe.

Includes Ordnance Survey Ireland data reproduced under OSI Licence number 2010/18CCMA/Galway County Council.  
Unauthorised reproduction infringes Ordnance Survey Ireland and Government of Ireland copyright. © Ordnance Survey Ireland, 2010.

© Ordnance Survey Ireland. All rights reserved. Licence number 2010/18CCMA/Galway County Council.

**Clients**

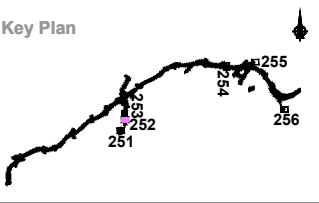

**Consultant**

Corporate House  
City East Business Park  
Ballybrit, Galway, Ireland.

Tel +353 (0)91 460675  
www.N6GalwayCity.ie  
www.arup.ie

**Job Title**  
N6 Galway City Ring Road

**Scale**  
1:1000 @ A3

**Date:**  
February 2018

Issue	Date	By	Chkd	Appd
I1	22/02/2018	AG	HK	EMC

**Drawing Title**  
Utility / Service Drawings  
Gas Diversion Requirements  
Sheet 2 of 6

**Drawing Status**

**For Information**

Job No	Drawing No	Issue
233985-00	GCOB-2700-D-252	11

**DESIGN REPORT**

- Legend:**
- City Boundary
  - Proposed Development Boundary
  - Proposed Road Development
  - Protect and maintain existing Gas Networks service
  - Proposed Diversion to service
  - Proposed Temporary Diversion to service
  - Decommissioned service
  - Proposed Sluice Valve
  - Existing Gas Networks service
  - Structure
  - Proposed Attenuation Pond / Infiltration Basin / Wetlands
  - Proposed Stream Diversion

For Continuation see Dwg No. GCOB-2700-0-252

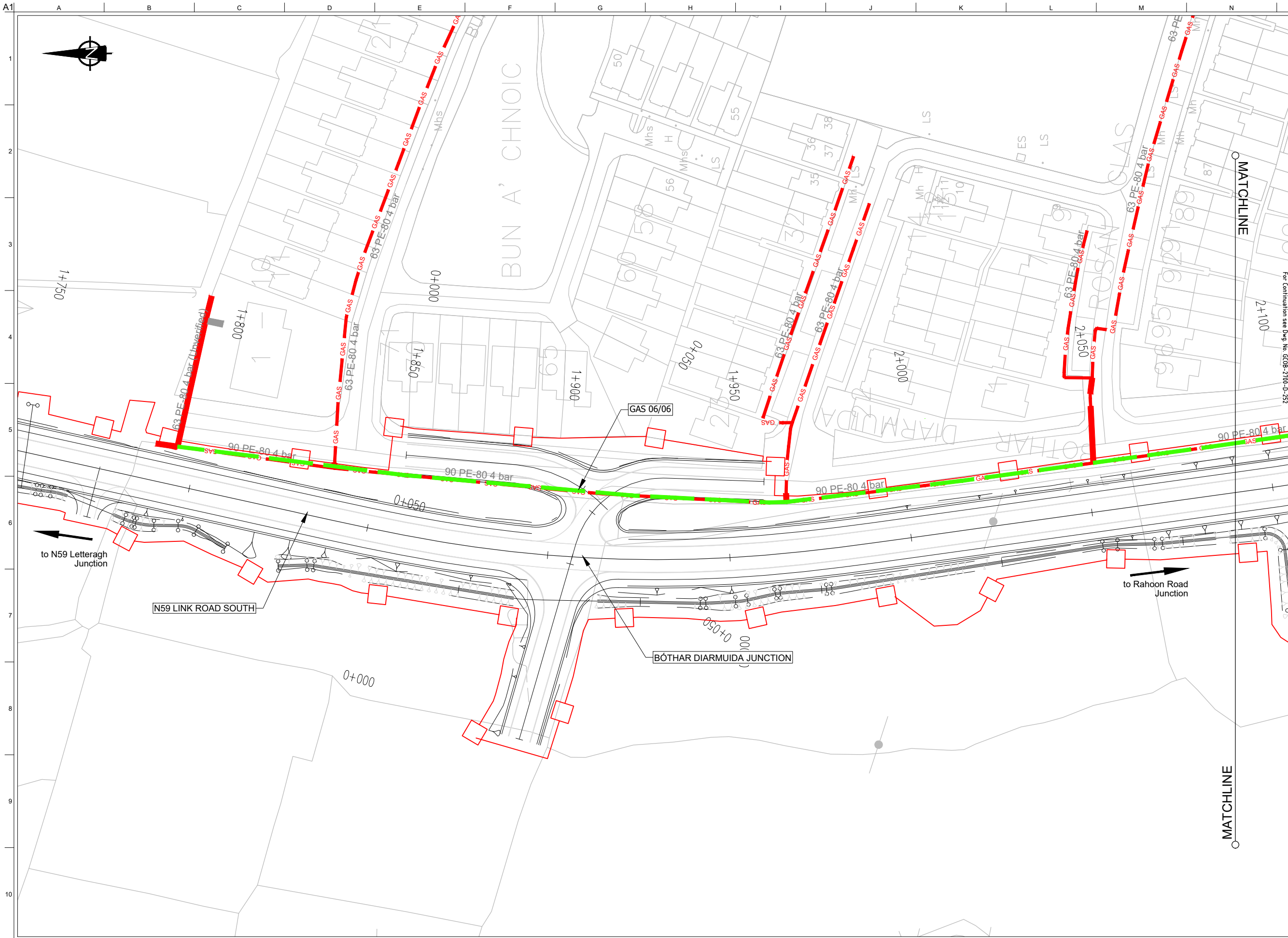

*San áireamh tá sonraíocht Shuirbhíreacht Orlándaís Éireann arna atáirgeadh fust Cheadúnas OSI Uimh. 2010/18CCMA/Comhairle Contae na Gaillimhe. Sírtaíonn atáirgeadh neamhdaraithe cóipeacht Shuirbhíreacht Orlándaís Éireann agus Rialtas na hÉireann. © Suirbhíreacht Orlándaís Éireann, 2010.*

© Suirbhíreacht Orlándaís Éireann. Gach ceart ar chosaint.  
Uimhir cheadúnais 2010/18CCMA/Comhairle Contae na Gaillimhe.  
Includes Ordnance Survey Ireland data reproduced under OSI Licence number 2010/18CCMA/Galway County Council.  
Unauthorised reproduction infringes Ordnance Survey Ireland and Government of Ireland copyrights. © Ordnance Survey Ireland, 2010.

© Ordnance Survey Ireland. All rights reserved. Licence number 2010/18CCMA/Galway County Council.

**Clients**

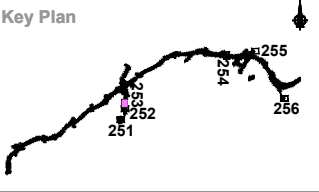

**Consultant**

Corporate House  
City East Business Park  
Ballybrit, Galway, Ireland.

Tel +353 (0)91 460675  
www.N6GalwayCity.ie  
www.arup.ie

**Job Title**  
N6 Galway City Ring Road

**Scale**  
1:1000 @ A3

**Date:**  
February 2018

Issue	Date	By	Chkd	Appd
I1	22/02/2018	AG	HK	EMC

**Drawing Title**  
Utility / Service Drawings  
Gas Diversion Requirements  
Sheet 3 of 6

**Drawing Status**

**For Information**

Job No	Drawing No	Issue
233985-00	GCOB-2700-D-253	11

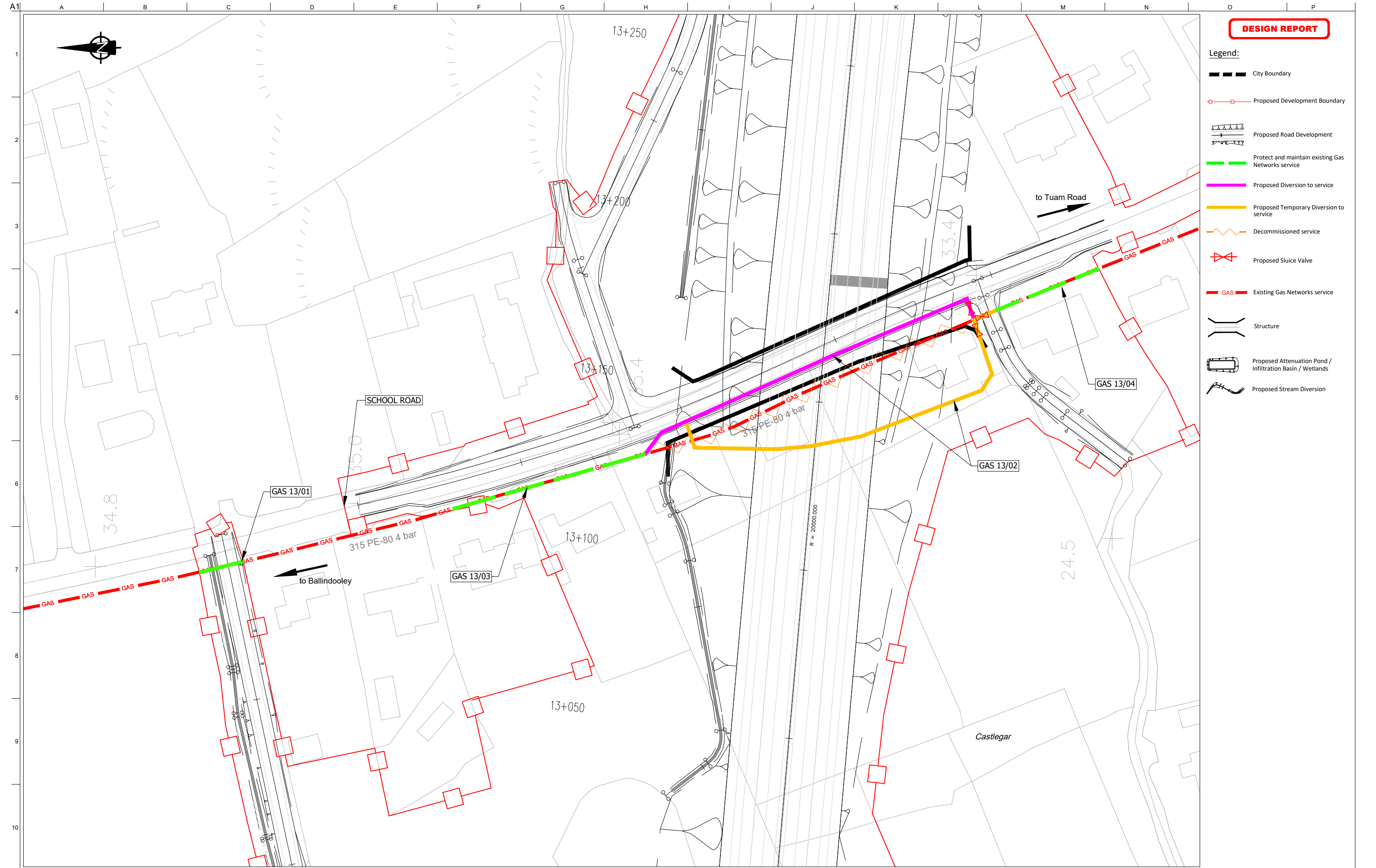

**DESIGN REPORT**

- Legend:**
- City Boundary
  - Proposed Development Boundary
  - Proposed Road Development
  - Protect and maintain existing Gas Networks service
  - Proposed Diversion to service
  - Proposed Temporary Diversion to service
  - Decommissioned service
  - Proposed Sluice Valve
  - Existing Gas Networks service
  - Structure
  - Proposed Attenuation Pond / Infiltration Basin / Wetlands
  - Proposed Stream Diversion

San áireamh tá sonraíocht Suirbhéireacht Orlánáis Éireann arna atáirgeadh fust Cheadúnas OSI Uimh. 2010/18CCMA/Comhairle Contae na Gaillimhe. Sírtaíonn atáirgeadh neamhdaraithe cóipeacht Suirbhéireacht Orlánáis Éireann agus Rialtas na hÉireann. © Suirbhéireacht Orlánáis Éireann, 2010.

© Suirbhéireacht Orlánáis Éireann. Gach ceart ar chosaint.  
Uimhir cheadúnais 2010/18CCMA/Comhairle Contae na Gaillimhe.

Includes Ordnance Survey Ireland data reproduced under OSI Licence number 2010/18CCMA/Galway County Council.  
Unauthorised reproduction infringes Ordnance Survey Ireland and Government of Ireland copyright. © Ordnance Survey Ireland, 2010.

© Ordnance Survey Ireland. All rights reserved. Licence number 2010/18CCMA/Galway County Council.

**Clients**

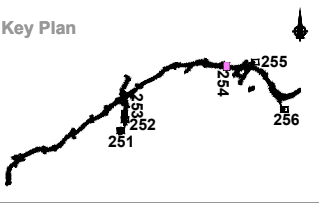

**Consultant**

Corporate House  
City East Business Park  
Ballybrit, Galway, Ireland.

Tel +353 (0)91 460675  
www.N6GalwayCity.ie  
www.arup.ie

**Job Title**  
N6 Galway City Ring Road

**Scale**  
1:1000 @ A3

**Date:**  
February 2018

Issue	Date	By	Chkd	Appd
I1	22/02/2018	AG	HK	EMC

**Drawing Title**  
Utility / Service Drawings  
Gas Diversion Requirements  
Sheet 4 of 6

**Drawing Status**

**For Information**

Job No	Drawing No	Issue
233985-00	GCOB-2700-D-254	11

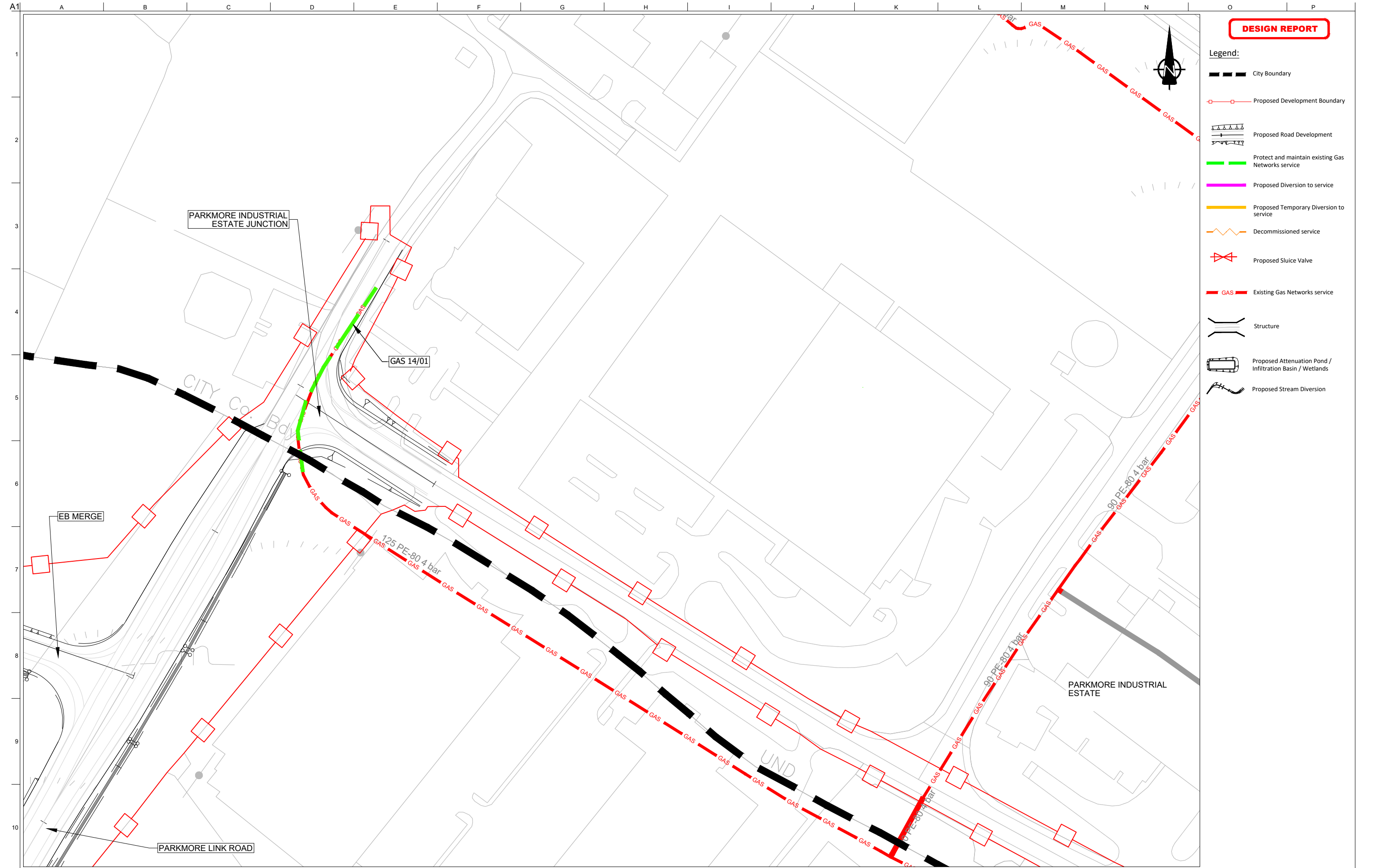

**DESIGN REPORT**

- Legend:**
- City Boundary
  - Proposed Development Boundary
  - Proposed Road Development
  - Protect and maintain existing Gas Networks service
  - Proposed Diversion to service
  - Proposed Temporary Diversion to service
  - Decommissioned service
  - Proposed Sluice Valve
  - Existing Gas Networks service
  - Structure
  - Proposed Attenuation Pond / Infiltration Basin / Wetlands
  - Proposed Stream Diversion



San áireamh tá sonraíocht Shuirbhíreacht Ordnáns Éireann arna atáirgeadh fúis Cheadúnas OSI Uimh. 2010/18CCMA/Comhairle Contae na Gaillimhe. Sírtaíonn atáirgeadh neamhdaraithe cóipeacht Shuirbhíreacht Ordnáns Éireann agus Rialtas na hÉireann. © Suirbhíreacht Ordnáns Éireann, 2010.

© Suirbhíreacht Ordnáns Éireann. Gach ceart ar chosaint.  
Uimhir cheadúnais 2010/18CCMA/Comhairle Contae na Gaillimhe.

Includes Ordnance Survey Ireland data reproduced under OSI Licence number 2010/18CCMA/Galway County Council.  
Unauthorised reproduction infringes Ordnance Survey Ireland and Government of Ireland copyrights. © Ordnance Survey Ireland, 2010.

© Ordnance Survey Ireland. All rights reserved. Licence number 2010/18CCMA/Galway County Council.

**Clients**

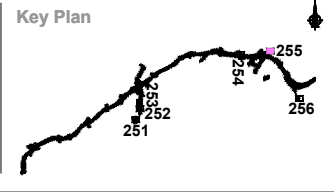

**Consultant**

Corporate House  
City East Business Park  
Ballybrit, Galway, Ireland.

Tel +353 (0)91 460675  
www.N6GalwayCity.ie  
www.arup.ie

**Job Title**  
N6 Galway City Ring Road

**Scale**  
1:1000 @ A3

**Date:**  
February 2018

Issue	Date	By	Chkd	Appd
I1	22/02/2018	AG	HK	EMC

**Drawing Title**  
Utility / Service Drawings  
Gas Diversion Requirements  
Sheet 5 of 6

**Drawing Status**

**For Information**

Job No	Drawing No	Issue
233985-00	GCOB-2700-D-255	11

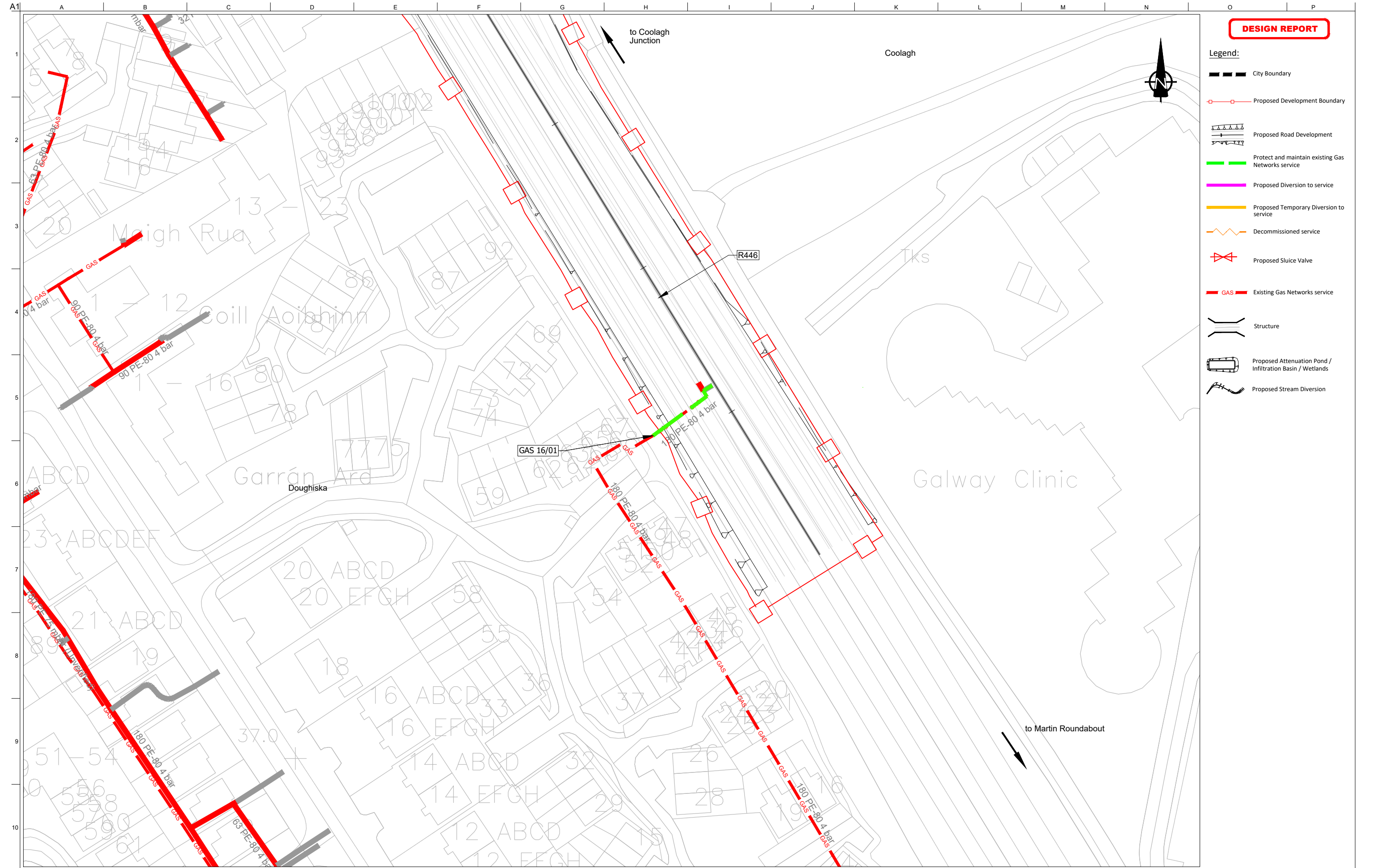

**DESIGN REPORT**

- Legend:**
- City Boundary
  - Proposed Development Boundary
  - Proposed Road Development
  - Protect and maintain existing Gas Networks service
  - Proposed Diversion to service
  - Proposed Temporary Diversion to service
  - Decommissioned service
  - Proposed Sluice Valve
  - Existing Gas Networks service
  - Structure
  - Proposed Attenuation Pond / Infiltration Basin / Wetlands
  - Proposed Stream Diversion



to Coolagh Junction

Coolagh

R446

Tks

Galway Clinic

Doughiska

to Martin Roundabout

GAS 16/01

San áireamh tá sonraíocht Shuirbhíreachtí Orlándaís Éireann arna áitirgeadh fust Cheadúnas OSI Uimh. 2010/18CCMA/Comhairle Contae na Gaillimhe. Sírtaíonn áitirgeadh neamhdaraithe cóipeacht Shuirbhíreachtí Orlándaís Éireann agus Rialtas na hÉireann. © Suirbhíreacht Orlándaís Éireann, 2010.

© Suirbhíreacht Orlándaís Éireann. Gach ceart ar chosaint.  
Uimhir cheadúnais 2010/18CCMA/Comhairle Contae na Gaillimhe.

Includes Ordnance Survey Ireland data reproduced under OSI Licence number 2010/18CCMA/Galway County Council.  
Unauthorised reproduction infringes Ordnance Survey Ireland and Government of Ireland copyright. © Ordnance Survey Ireland, 2010.

© Ordnance Survey Ireland. All rights reserved. Licence number 2010/18CCMA/Galway County Council.

**Clients**

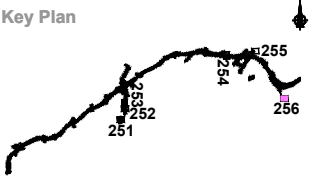

**Consultant**

Corporate House  
City East Business Park  
Ballybrit, Galway, Ireland.

Tel +353 (0)91 460675  
www.N6GalwayCity.ie  
www.arup.ie

**Job Title**  
N6 Galway City Ring Road

**Scale**  
1:1000 @ A3

**Date:**  
February 2018

Issue	Date	By	Chkd	Appd
I1	22/02/2018	AG	HK	EMC

**Drawing Title**  
Utility / Service Drawings  
Gas Diversion Requirements  
Sheet 6 of 6

**Drawing Status**

**For Information**

Job No	Drawing No	Issue
233985-00	GCOB-2700-D-256	11